

ARROWSTREET
ARCHITECTURE & DESIGN

10 POST OFFICE SQUARE
SUITE 700N
BOSTON MA 02109
617.623.5555
www.arrowstreet.com



GARCIA GALUSKA DESOUSA
CONSULTING ENGINEERS
207 FRENCH CREEK DRIVE, SUITE 100
BOSTON, MA 02116
617.552.1000 FAX 617.552.1001

**HILDRETH
ELEMENTARY
SCHOOL**
27 Massachusetts Ave.
Harvard, MA 01451

**CONSTRUCTION
DOCUMENTS**

No.	Date	Description
1	1-25-2019	ERP ADDM #1

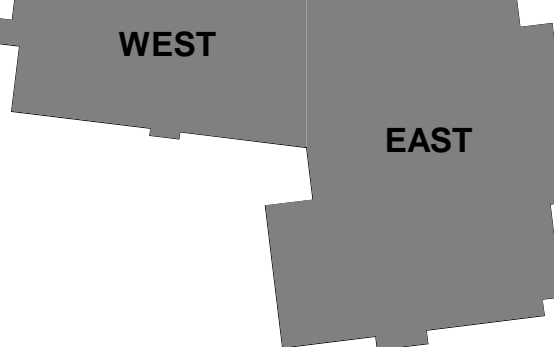
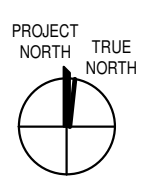

**ELECTRICAL
SITE PLAN**

Project No.	16073
Drawn By	GGD
Date	04/26/2019
Scale	As indicated

E0.03

ELECTRICAL SITE NOTES:

- DO NOT RUN ANY UNDERGROUND RACEWAYS WITHIN PLANTING AREAS OR LEACHING FIELDS. REFER TO DRAWINGS FOR LOCATIONS. COORDINATE ROUTING WITH LANDSCAPE ARCHITECT.
- REFER TO CIVIL DRAWINGS FOR EXACT ROUTING OF UTILITIES. REFER TO LANDSCAPE DRAWINGS FOR EXACT LOCATION OF SITE FIXTURES.
- ALL SITE WIRING SHALL BE 288A100, 1" MINIMUM UNLESS SHOWN OTHERWISE.
- ALL EXTERIOR LIGHTING TO BE PROGRAMMED FOR PHOTOCELL, 10% TIMED OFF, AND DIMMED LEVELS (VIA 2-100 SIGNAL). PROVIDE INDIVIDUAL CONTROL FOR EACH CIRCUIT. COORDINATE PROGRAMMING WITH OWNER. REFER TO ALC'S ONE-LINE DIAGRAM & SPECIFICATIONS.
- REFER TO ARCHITECTURAL DRAWINGS FOR EXACT LOCATION OF EXTERIOR WALL MOUNTED LIGHTING.
- REMOVE ALL SITE ELECTRICS WHEN NO LONGER REQUIRED.
- PROVIDE 17"x21" GROUND MOUNTED PULL BOX (QUARTZITE HPC1728B12 WITH COVER HPC1728C117 OR SAME BY CARSON, HORNLINE, STROMWELL, OR EQUAL) AT ALL POLES WITH THREE PULL BOX AND NEEAREST ELECTRICAL ROOM LABEL @ EACH END. PROVIDE LIGHTNING PROTECTION SYSTEM FOR COVERAGE OF ENTIRE FACILITY.
- PROVIDE 12"x12" GROUND MOUNTED PULL BOX (QUARTZITE HPC1228B12 WITH COVER HPC1228C117 OR SAME BY CARSON, HORNLINE, STROMWELL, OR EQUAL) AT ALL POLES WITH THREE PULL BOX AND NEEAREST ELECTRICAL ROOM LABEL @ EACH END. PROVIDE LIGHTNING PROTECTION SYSTEM TO ALLOW FOR SINGLE PHASE TO ENTER BASE.
- GENERATOR EMISSIONS EXHAUST SHALL MAINTAIN 25 FEET CLEARANCE FROM ANY OPERABLE WINDOWS OR INTAKE LOUVERS. COMPLY WITH ALL FEDERAL, EPA AND STATE DEP REQUIREMENTS.

SITE WIRING LEGEND:

- ① 2# 14100, 1" C, 2' BELOW GRADE & 2#12 SHIELDED CABLE @ 10' DV 1" C, 2' BELOW GRADE.

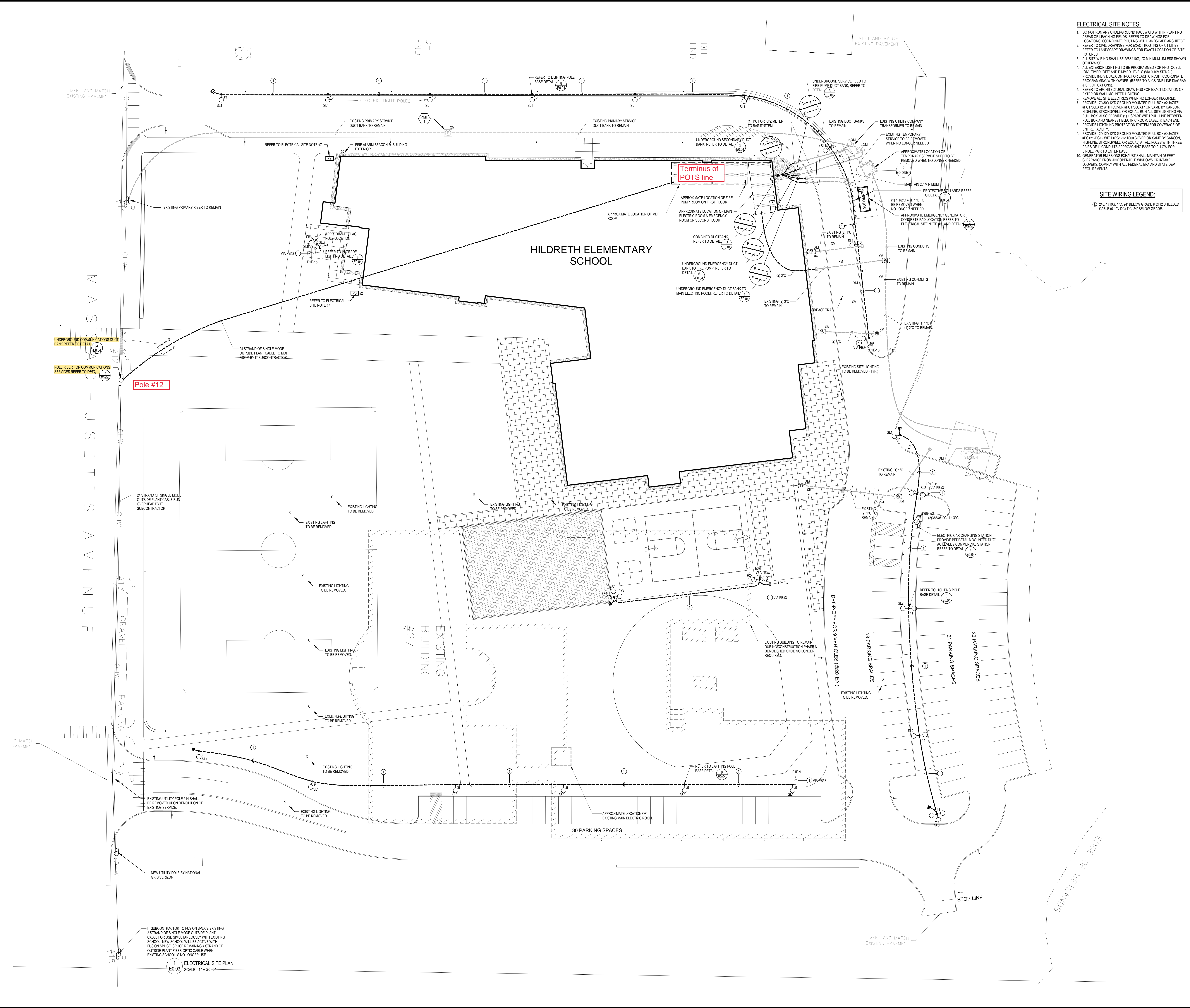

1 ELECTRICAL SITE PLAN
E0.03 SCALE: 1" = 20'-0"