

FIELD REPORT

Nitsch Project #:	12808	Date:	November 21, 2019
Client:	Pine Hill Village, LLC	Time:	8:30 AM
Project:	Pine Hill Development	Location:	Harvard, Massachusetts
Weather:	Sunny, 45°F		
Present:	Gavin Graham, Nitsch Engineering		

The purpose of this site visit was to observe general site conditions, observe general construction activities, and erosion & sedimentation control measures. The following was noted:

1. Nitsch Engineering observed loose gravel being brought into the construction site through the construction entrance pad. It appeared to be brought in by way of the tree clearing machinery. See **Figure 1** and attached map.
2. There are several locations along the fence where trees/large limbs were cut and fell on the fence, damaging the integrity of the erosion control. These locations are marked on the map and are included in **Figures 2, 3, and 4**.
3. Tree clearing company Burl Land Clearing & Stump Grounding was on site actively clearing out trees. See **Figure 5**.
4. Clearing of trees has commenced and contractor is staying within phase 1 limits. See **Figure 6**.



Figure 1



Figure 2



Figure 3



Figure 4



Figure 5



Figure 6

Past Recommended Items to be Completed:

- n/a

New Recommended Items to be Completed:

1. Contractor to maintain stabilized construction entrance and prevent gravel from tracking into the site.
2. Contractor to minimize tree limbs and branches from falling on to and damaging erosion controls.
3. ***Requires further action:** Contractor to repair any erosion control that is damaged or fallen, as soon as possible.

Pine Hill Village, LLC: Nitsch Project #12808
November 21, 2019
Page 3 of 3

If there are any questions, please call:

Gavin Graham

Gavin Graham
Project Designer

GG

cc: Project File

Q:\12808 Pine Hill 40B\Civil\CA\Field Reports\2019-11-21

11/21 Field Notes:
- There are several locations along the fence where trees/ large limbs were cut and fell on the fence, damaging the integrity of the fence. These locations have been marked on the map and photographed.
- Gravel from the staging area has been tracked in on the north side entrance and needs to be cleared.
- Note the presence of Burl Land Clearing & Stump Grounding on site actively clearing site.

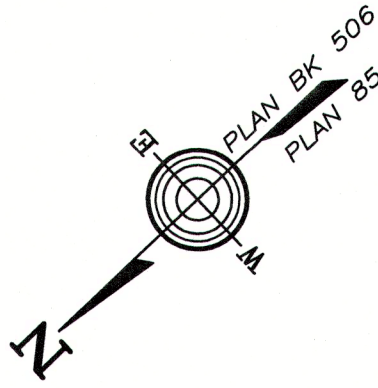

LOOSE GRAVEL
BEING BROUGHT
ON SITE

LIMIT OF PHASE 1
CONSTRUCTION

LIMIT OF PHASE 2
CONSTRUCTION

LIMIT OF PHASE 3
CONSTRUCTION

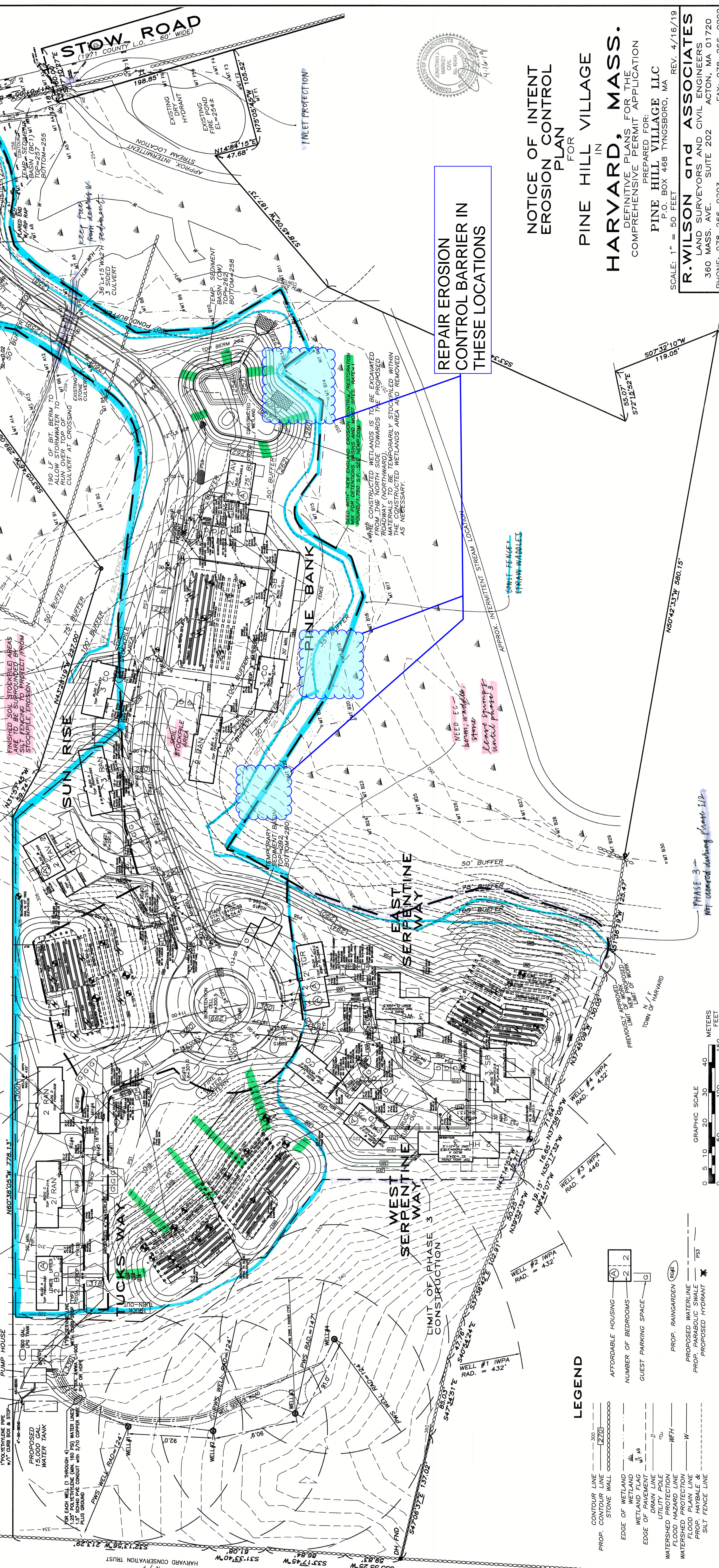

REPAIR EROSION
CONTROL BARRIER IN
THESE LOCATIONS

NOTICE OF INTENT
EROSION CONTROL
PLAN
FOR

PINE HILL VILLAGE
IN

HARVARD, MASS.

DEFINITIVE PLANS FOR THE
COMPREHENSIVE PERMIT APPLICATION

PREPARED FOR:

PINE HILL VILLAGE LLC

P.O. BOX 468 TYNGSBORO, MA

SCALE: 1" = 50 FEET

REV. 4/16/19

R. WILSON and ASSOCIATES

LAND SURVEYORS AND CIVIL ENGINEERS

360 MASS. AVE. SUITE 202

ATLANTIC, MA 01720

PHONE: 978-266-0203

FAX: 978-266-0202

FILE NO. 1009/5086 DWG: 1009-5086 SITE 2018 R2 SWPPP SHEET 6